

Wiring Diagrams

Earth Return

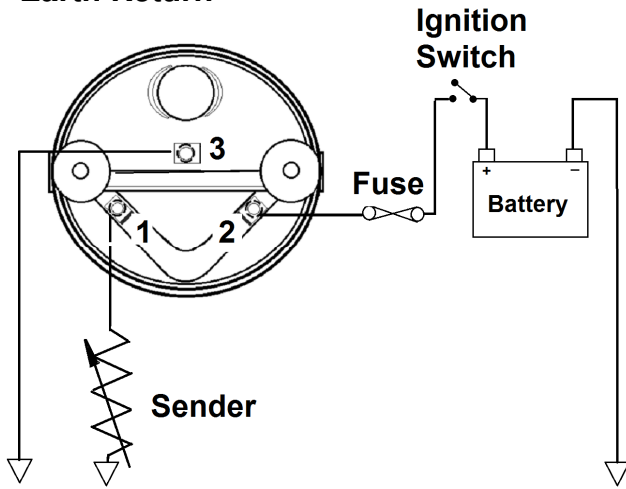

Insulated Return

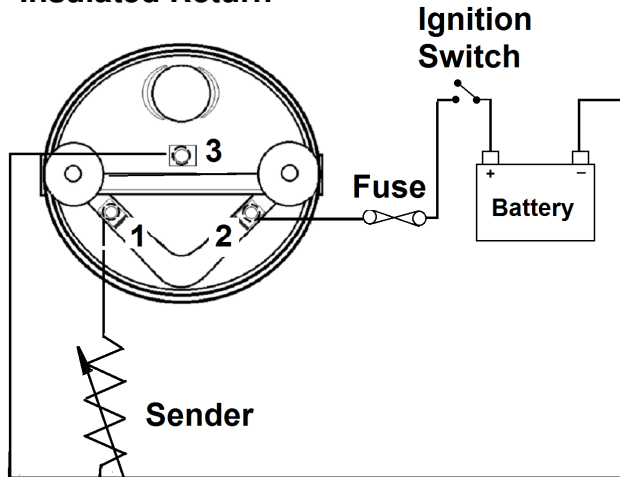

Note: If unit is earth return and electrical connection is made via a stud, one of the fixing bolts may be used as the electrical ground. The wire should be securely crimped to a suitable terminal and inserted under the fixing bolt before fully tightening.

Calibration Tables

Metric		
Depth	Pivot	Radius
180	77	78
200	88	92
220	98	105
240	109	119
260	119	132
280	130	146
300	141	159
320	151	173
340	162	186
360	172	200
380	183	213
400	194	227
420	204	240
440	215	254
460	225	267
480	236	281
500	247	294
520	257	308
540	268	321
560	278	335
580	289	348
600	300	362
620	310	375
640	321	389
660	331	402

Imperial		
Depth	Pivot	Radius
7.0	3.0	3.0
7.8	3.4	3.5
8.6	3.8	4.1
9.4	4.3	4.6
10.2	4.7	5.1
11.0	5.1	5.7
11.7	5.5	6.2
12.5	5.9	6.7
13.3	6.4	7.2
14.1	6.8	7.8
14.9	7.2	8.3
15.7	7.6	8.8
16.5	8.0	9.4
17.3	8.5	9.9
18.1	8.9	10.4
18.9	9.3	11.0
19.6	9.7	11.5
20.4	10.1	12.0
21.2	10.6	12.5
22.0	11.0	13.1
22.8	11.4	13.6
23.6	11.8	14.1
24.4	12.2	14.7
25.2	12.7	15.2
26.0	13.1	15.7



Caerbont Automotive Instruments

"The original makers of SMITHS Instruments"

Installation Instructions For Fuel Level Senders

Part No.	Description
TA9x1x series	10ohms empty to 180ohms full
TA9x3x series	240ohms empty to 33ohms full
TA9x4x series	240ohms empty to 20ohms full
TA9x5x series	325 ohms empty to 20 ohms full
TA9x7x series	78 ohms empty to 10ohms full
TA9x9x series	0 ohms empty to 90 ohms full

Caerbont Automotive Instruments Ltd
Abercrave, Swansea, SA9 1SH

Tel: +44 (0) 1639 732200

Fax: +44 (0) 1639 732201

www.caigauge.com

Fitting Instructions

We recommend you read all instructions and notes prior to beginning installation

CAUTION

Disconnect the Battery Negative Cable Prior to Installation

Measure the internal depth of the fuel tank.

From the table, select pivot dimension and float arm radius against tank depth measured.

Slide the retaining clips and the float onto the flat arm wire and adjust to the correct radius. The clips can be pushed onto, or moved along the wire by squeezing the ends together.
SAFETY PRECAUTION: - Float arm wire is sharp. Take care when handling to prevent injury.

Slide the resistor box onto the rod, ensuring the orientation is as shown in the diagram, and adjust to approximately the correct pivot height. Mark the rod at the bottom of the lower adjusting bracket.

Remove the resistor box and cut off the excess rod below the adjusting bracket with a hacksaw.

Attach the square nut and bolt BUT DO NOT TIGHTEN.

Holding the resistor box, rotate the flange to the correct float arm orientation tightening the wire around the rod so that the wire does not interfere with the operation of the float arm.

Position the resistor box to the correct pivot height and orientation and fully tighten the screws until the surfaces of the adjusting bracket meet and the box is securely fastened to the rod.

Slide the gasket over the float, along the arm, over the resistor box and up to the underside of the flange.

Correctly orientate the gasket. For the five hole variant, position the notch in the gasket opposite the index hole in the fixing plate prior to inserting the unit into the tank.

Install the unit, float first, into the tank and align the screw holes with those on the mounting flange and sealing gasket.

Insert all mounting screws and tighten securely. DO NOT OVERTIGHTEN.

Note:

- Prior to installing into tank, connect the gauge and the sender together to check the gauge reads full when the float arm is in the 'full' position and reads empty when the float is in the 'empty' position. (If your gauge is reading in reverse, it is likely that the resistor box has been fitted upside down – please check orientation with diagram).

Mounting Screws (5 off)

TA9x3x series
 TA9x4x series
 TA9x5x series
 TA9x7x series

Wrap wire around rod as shown, ensuring that wire does not interfere with the operation of the float arm.

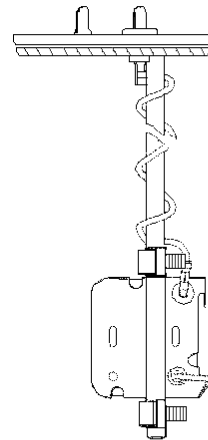
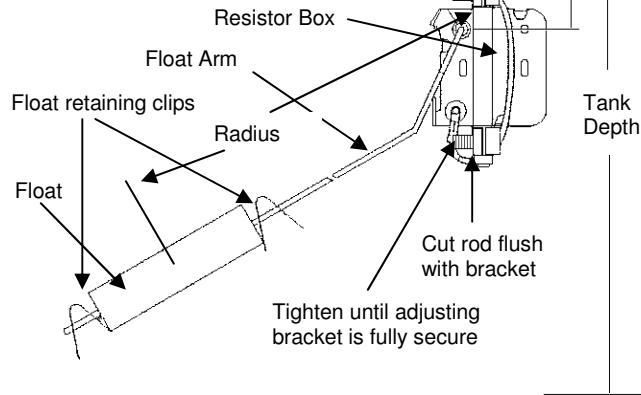

TA9x1x series
 TA9x9x series

Note orientation of resistor box for these units

FLANGE

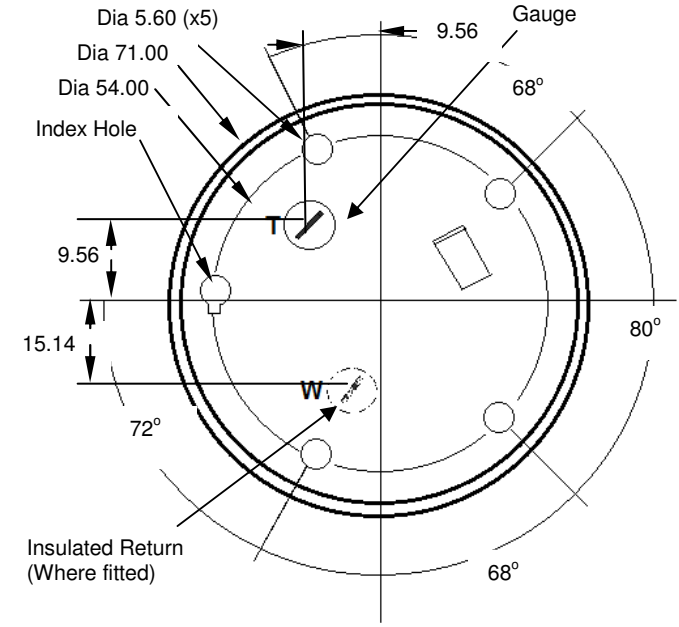

GASKET

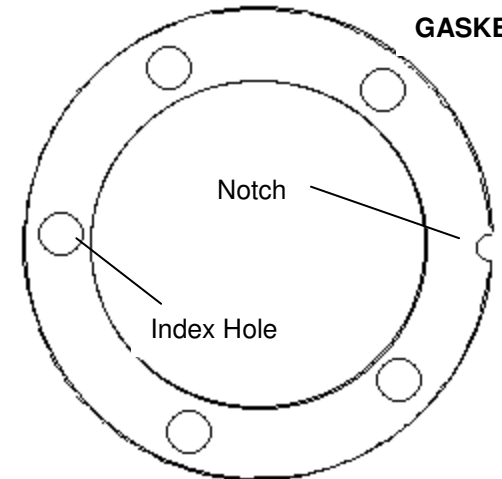

Notes:

- Modifications to fuel tanks should only be attempted with the tank removed from the vehicle, emptied, cleaned and dried.
- Recommended aperture diameter in tank 44.0mm (minimum diameter 43.0mm).